



115VAC INTERIOR LED WASH LIGHT

HIGHLY RELIABLE CEILING & SIDEWALL LIGHTING FOR A MODERN CABIN

This 115VAC wash light was designed to replace fluorescent lighting systems with a brighter, more intense light that operates directly off aircraft power. With several color temperature and dimming options, the ELW83 is an excellent lighting system for airlines.

FEATURES & BENEFITS

- Operates directly off 115VAC/400Hz aircraft power eliminating need for, and weight of, ballasts and power supplies
- Built in step dimming for 10%, 30%, 50% and 100% illumination
- Easy to install and maintain
- Eliminate bulb breakage with LEDs, no ballasts
- Three color temperature options
- Refresh cabin interiors for a newer aircraft look
- Ideal for wide or narrow body aircraft
- PMA
- DO-160E tested



ELW83 wash lighting is an effective way to modernize aircraft interiors while increasing reliability and reducing maintenance costs.

SPECIFICATIONS

Optical

Color temperature: 3350K, 4000K, 4900K

Intensity: 10.8 footcandle

Based on exposed 12" (305mm) section 36" (914mm) away at 100% intensity. Varies based on color temperature.

Electrical

Operating voltage: 115VAC

Current draw: 230mA - 70mA (based off 48" length light)
Varies based on intensity

Mechanical

Weight: 4oz/ft (115g)

Flammability

Meets FAR part 25 for burn smoke PAR 25.853 Appendix F, Part 1 (a)(1)(ii)

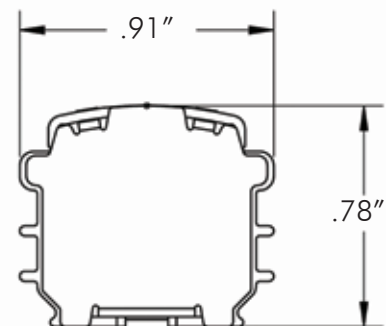

ELW83 mechanical dimensions

High Brightness ELW83 Order Guide

ELW83 - 2 XX X OX - X

EMTEQ 115VAC Wash Light

Length (inches)

13 = 13" (330mm)	24 = 24" (609mm)	36 = 36" (914mm)	48 = 48" (1219mm)
16 = 16" (406mm)	28 = 28" (711mm)	38 = 38" (965mm)	
18 = 18" (457mm)	30 = 30" (762mm)	40 = 40" (1016mm)	
20 = 20" (508mm)	32 = 32" (813mm)	42 = 42" (1067mm)	
22 = 22" (559mm)	34 = 34" (864mm)	44 = 44" (1118mm)	

Color Temperature Options

1 = 3350K	2 = 4000K	3 = 4900K
-----------	-----------	-----------

Lens Style

0 = Clear

Termination

1 = Mini fit Jr. Connector (6 pin)

VALUE-ADDED CAPABILITIES

ENSURING COMPREHENSIVE SOLUTIONS AND SUPPORT FOR YOUR PROGRAM'S SUCCESS.

- Project and program management including on-site engineering support
- On-site technical support, 24-hour AOG support, and installation services
- In-house FAA DER, DAR, DMIR, and PMA certification expertise; FAA consulting services including DER major alteration approval
- Product development, design, testing and analytical services
- FAA and EASA STC development and design data package development with FAA Partnership for Safety Plan and sales/local authority certification approval coordination
- FAA and EASA approved structural repair development
- Transport Canada Aeronautical Products Manufacturer and Maintenance Organization approvals and Transport Canada Design Approval Organization at ACS-NAI
- Subcontract manufacturing services to airframe manufacturers and maintenance organizations

QUALITY ASSURANCE

EMTEQ's global quality inspection programs comply with EN/JSIQ/AS9100:2004, ISO9001:2008, or EN9100:2003 standards, as well as airframe OEM standard compliance for the consistent production of high performance products. EMTEQ has an approved FAA/EASA Part 145 Repair Station in New Berlin and an EASA Part 145 Repair Station in Switzerland. EMTEQ's New Berlin office is an FAA/PMA approved manufacturing facility. Additionally, we provide first article inspection, customer drawing log and revision control, as well as warehousing and lot control of customer supplied parts.

CONTACT US TODAY TO DISCUSS HOW WE CAN SUPPORT YOUR SPECIFIC NEEDS.

EMTEQ, Inc.

5349 S. Emmer Drive
New Berlin, WI 53151 USA
ph: +1 262-679-6170
sales@emteq.com
www.emteq.com

ACS-NAI, Ltd.

Winnipeg, MB Canada
ph: +1 204-783-5402

ACS-NAI Montreal
Saint-Laurent, QC Canada
ph: +1 514-312-6054

EMTEQ Engineering

Miramar, FL USA
ph: +1 305-863-1600

EMTEQ Europe GmbH
Bachenbülach, Switzerland
ph: +41 44 218 12 00

EMTEQ do Brasil, Ltda.

Taubaté - SP - Brazil

